

DOMESTIC HOT WATER MIXING VALVE

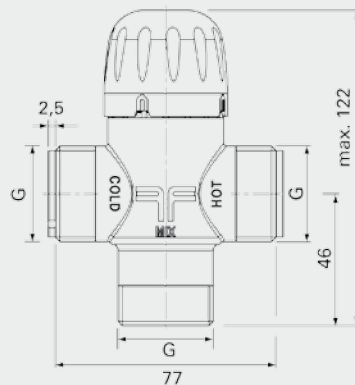

Benefits

- Constant water temperature at the point of withdrawal
- Self-actuating mixing function without supplementary energy
- Infinitely variable adjustment of the mixed water temperature
- High control precision
- Protection from scalding
- High kVS values
- Very low cold water leakage rate
- Non-stick coating of the valve housing against limescale
- Locking option of the target value setting
- Can be used as a diverting valve
- No additional seals are required when used as return flow inhibitor
- Return flow inhibitors are secured against loss

Product description

A self-actuating thermostatic domestic hot water mixing valve acts as a central mixing unit and ensures a constant mixed water temperature at the point of withdrawal. Scalding at the point of withdrawal is thereby avoided even at high tank temperatures. Special valve seals at the control piston reduce unwanted admixtures to a minimum*, resulting in maximum utilisation of the tank temperature. Long service life thanks to high-quality plastics and non-stick coatings against limescale. Infinitely adjustable target temperature.

Mode of function

The mixing valve is supplied with hot water from a tank and with cold water from the line network. The temperature of the mixed water is registered by a thermostatic expansion element. A deviation in the temperature of the mixed water from the target value will cause the expansion element to move the control piston, and thereby regulate the supply of hot and cold water until the mixed water temperature corresponds to the target value.

*When the hot water is 3 K below the set mixed water temperature, then the cold water leakage rate = 0. Otherwise the admixture is limited to max. 3 K.

Specifications

Type	BMV 34	BMV 1
Item no.	1510565	1510566
Connection	1" male thread with 3/4" reduct. thread. conn.	5/4" male thread with 1" threaded connection
Housing	Brass, dezincification resistant (with anti-limescale coating)	
Interior parts	High-quality plastic	
Seals	EPDM	
Flow media	Drinking water, heating water (VDI 2035; SIA Directive 384/1; ÖNORM H 5195-1)	
Max. operating temperature	TB max. 100 °C	
Max. operating pressure	10 bar	
Min. operating pressure	0.5 bar	
Max. dynamic working pressure	5 bar	
Max. steady inlet pressure difference	2 bar	
Adjustable temperature range	45–65 °C (designed according to EN15092)	
Temperature stability of mixture	Max. 3 K (in case of hot water temperature change 15 K)	
Noise classification	2	
Installation position	Any	
Insulation (accessory – order separately)	EPP	

Pressure loss diagram

