

# COLLECTOR PFM + PFM-G

## UNIVERSAL GUY CABLE SET FOR JOINT TIN ROOFS

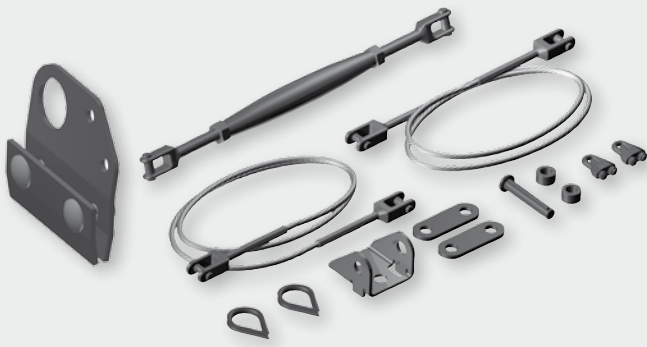

### Description

For securing collectors on tin joint roofs against the wind, comprising a guy cable, turnbuckle and fastenings for collector frames and a joint clamp for guy cable tensioning. Material: Stainless steel.

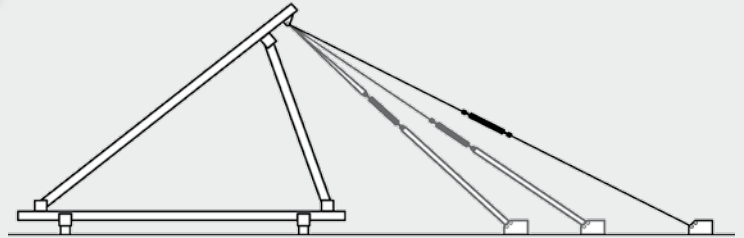

**Note:** Eight guy cable length variants possible

### Specifications

Possible guy cable lengths approximately: 0.8 m / 0.9 m / 1.4 m / 1.6 m / 1.7 m / 2.2 m / 2.3 m / 2.9 m

Qty.	Designation	Material
1	Turnbuckle	A4 stainless steel
1	Cable L=1200 (clevis/clevis)	A4 stainless steel
1	Cable L=1500 (clevis/clevis)	A4 stainless steel
2	Cable clip	A2 stainless steel
2	Guy cable set clevis connector plate	A2 stainless steel
1	Fastening bracket for guy cable set	A2 stainless steel
2	Cable thimble	A2 stainless steel
2	M8x18 hexagon bolt	A2 stainless steel
2	M8 hexagon nut	A2 stainless steel
2	M8 washer	A2 stainless steel
2	Square washer	A2 stainless steel
1	M10x16 hexagon bolt	A2 stainless steel
1	M10 washer	A2 stainless steel
1	M10 sliding nut	Galvanised steel
1	Joint clamp for guy cable set	see below

## JOINT CLAMP FOR GUY CABLE SET

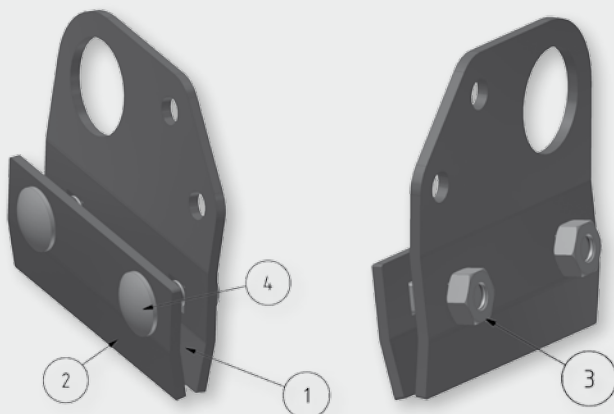

### Description

The joint clamp is required for mounting the guy cable set on joint tin roofs with galvanised or coated sheet steel or sheet copper. (One in each guy cable set). The guy cable set is fastened to the joint clamp using shackles (supplied with the guy cable set).

**Note:** The joint clamp can also be used with a 1" pipe provided on site as an additional snow guard above the collector (does not replace the snow guard system provided on site which is an absolute requirement).

### Caution

- Not recommended for titanium-zinc sheet due to danger of cracks at low temperatures
- Any stainless steel screws used may not be reused after they have been undone (danger of breakage)

### Specifications

Length approx: 112 mm, height approx. 110 mm

No.	Designation	Material
1	Joint clamp for cable fastening part 1	Stainless steel 1.4301
2	Joint clamp part 2	Stainless steel 1.4301
3	Hexagon nut M10-8 DIN 934	Galvanised steel and Geomet 500 coated
4	M10x25 - 8.8 DIN 603 cup square carriage bolt	Galvanised steel and Geomet 500 coated